

VIEW A-A

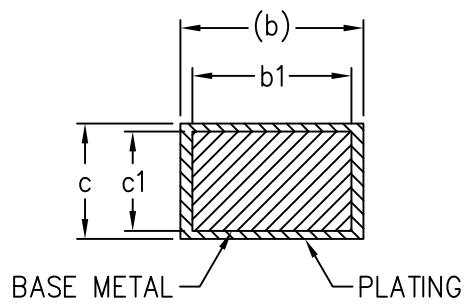

SECTION B-B

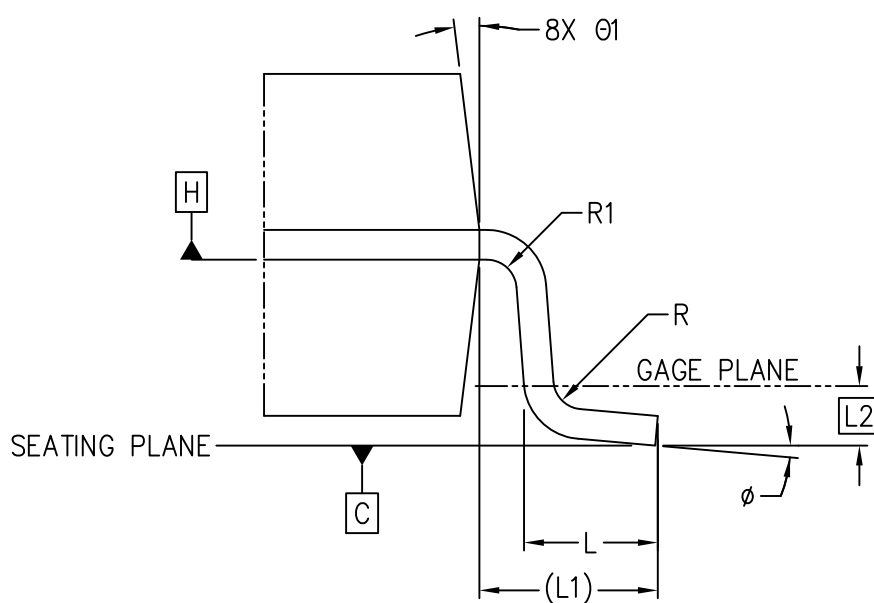

DETAIL C

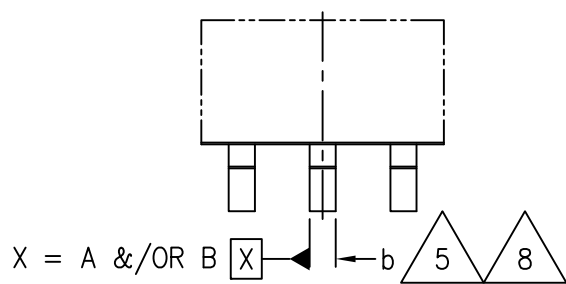

ODD LEAD SIDES  
TOPVIEW

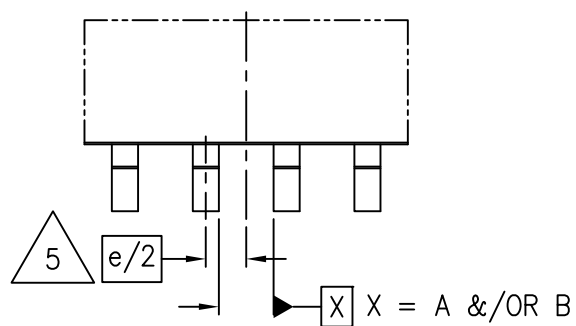

EVEN LEAD SIDES  
TOPVIEW

TABLE 1

COMMON DIMENSIONS				
SYMBOL	MIN	NOM	MAX	NOTES
A	---	---	1.45	
A1	0	---	0.15	
A2	0.90	1.15	1.30	
c	0.08	---	0.22	7
c1	0.08	0.13	0.20	7
D	2.90 BASIC			3, 4
E	2.80 BASIC			3, 4
E1	1.60 BASIC			3, 4
L	0.30	0.45	0.60	
L1	0.60 REF			
L2	0.25 BASIC			
R	0.10	---	---	
R1	0.10	---	0.25	
∅	0°	4°	8°	
∅1	0°	10°	15°	
NOTES	1, 2			
REF	10-378, 10-458			
ISSUE	D			

TABLE 2

TOLERANCE OF FORM AND POSITION	
SYMBOL	
aaa	0.15
bbb	0.20
ccc	0.10
NOTES	1, 2
REF	10-378
ISSUE	B

TABLE 3

VARIATION										
SYMBOL	PDSO—G5_I0P95— R2p9x1p6Z1p45— N2p8T0p22			PDSO—G6_I0P95— R2p9x1p6Z1p45— N2p8T0p22			PDSO—G8_I0P65— R2p9x1p6Z1p45— N2p8T0p22			NOTES
	MIN	NOM	MAX	MIN	NOM	MAX	MIN	NOM	MAX	
b	0.30	---	0.50	0.30	---	0.50	0.22	---	0.38	7
b1	0.30	0.40	0.45	0.30	0.40	0.45	0.22	0.30	0.33	7
e	0.95 BASIC			0.95 BASIC			0.65 BASIC			
e1	1.90 BASIC			1.90 BASIC			1.95 BASIC			
N	5			6			8			
TOLERANCE OF FORM AND POSITION										
ddd	0.20			0.20			0.13			
NOTES	1, 2, 6, 8			1, 2, 8			1, 2, 8			
REF	10—378, 10—458			10—397, 10—458			10—397, 10—458			
ISSUE	D			D			D			

NOTES:

1. DIMENSIONING AND TOLERANCING PER ASME Y14.5M-1994.

2. DIMENSIONS IN MILLIMETERS.



DIMENSION D DOES NOT INCLUDE MOLD FLASH, PROTRUSIONS OR GATE BURRS. MOLD FLASH, PROTRUSIONS OR GATE BURRS SHALL NOT EXCEED 0.25 mm PER END. DIMENSION E1 DOES NOT INCLUDE INTERLEAD FLASH OR PROTRUSION. INTERLEAD FLASH OR PROTRUSION SHALL NOT EXCEED 0.25 mm PER SIDE. D AND E1 DIMENSIONS ARE DETERMINED AT DATUM H



THE PACKAGE TOP MAY BE SMALLER THAN THE PACKAGE BOTTOM. DIMENSIONS D AND E1 ARE DETERMINED AT THE OUTERMOST EXTREMES OF THE PLASTIC BODY EXCLUSIVE OF MOLD FLASH, TIE BAR BURRS, GATE BURRS AND INTERLEAD FLASH, BUT INCLUDING ANY MISMATCH BETWEEN THE TOP AND BOTTOM OF THE PLASTIC BODY. D AND E1 DIMENSIONS ARE DETERMINED AT DATUM H.



DATUMS A & B TO BE DETERMINED AT DATUM H.



PACKAGE VARIATION "AA" IS A 5 LEAD VERSION OF THE 6 LEAD VARIATION "AB" WHERE LEAD #5 HAS BEEN REMOVED FROM THE 6 LEAD "AB" VARIATION.



THESE DIMENSIONS APPLY TO THE FLAT SECTION OF THE LEAD BETWEEN 0.08 mm AND 0.15 mm FROM THE LEAD TIP.



DIMENSION 'b' DOES NOT INCLUDE DAMBAR PROTRUSION. ALLOWABLE DAMBAR PROTRUSION SHALL BE 0.08 mm TOTAL IN EXCESS OF THE "b" DIMENSION AT MAXIMUM MATERIAL CONDITION. THE DAMBAR CANNOT BE LOCATED ON THE LOWER RADIUS OF THE FOOT. MINIMUM SPACE BETWEEN PROTRUSION AND AN ADJACENT LEAD SHALL NOT BE LESS THAN 0.07 mm.



DETAILS OF THE PIN 1 IDENTIFIER ARE OPTIONAL, BUT MUST BE LOCATED WITHIN THE ZONE INDICATED.

# STP (3D) FILE RECORD

3D FILE NAMES MAY EXCEED LENGTH REQUIREMENTS FOR SOME SOFTWARE TOOLS.

STP FILE NAME	ISSUE	DATE	ITEM NUMBER

TASK GROUP CONTRIBUTORS

TEXAS INSTRUMENTS INC.

# CHANGE RECORD

IF THE CHANGE INVOLVES ANY WORDS ADDED OR DELETED (EXCLUDING DELETION OF ACCIDENTALLY REPEATED WORDS), THE CHANGE IS TO BE INCLUDED BELOW. PUNCTUATION CHANGES MAY OR MAY NOT BE INCLUDED.

INITIAL ISSUE: A	DATE: SEPTEMBER 1995	ITEM NUMBER: 10-355
------------------	----------------------	---------------------

ISSUE: B	DATE: JANUARY 1999	ITEM NUMBER: 10-378
----------	--------------------	---------------------

ISSUE: C	DATE: FEBRUARY 2000	ITEM NUMBER: 10-397
----------	---------------------	---------------------

ISSUE: D	DATE: SEPTEMBER 2020	ITEM NUMBER: 10-458
----------	----------------------	---------------------

LOCATION:	CHANGED FROM:	CHANGED TO:
SHEET 1, TITLE	PLASTIC SMALL OUTLINE PACKAGE (SOT / SOP)	PLASTIC DUAL SMALL OUTLINE GULL WING PACKGE, 1.45MM THICK
SHEET 1, PKG DESIGNATOR	R-PDSO-G	PDSO-G#_IOP##-##...
SHEET 3	ø1 WAS 5° MIN	ø1 CHANGED TO 0° MIN
SHEET 4, VARIATIONS	AA	PDSO-G5_IOP95-R2p9x1p6Z1p45-N2p8T0p22
	AB	PDSO-G6_IOP95-R2p9x1p6Z1p45-N2p8T0p22
	BA	PDSO-G8_IOP65-R2p9x1p6Z1p45-N2p8T0p22